

**MARICOPA  
COUNTY  
RECORDER**



“ THE RECORDER’S OFFICE MANIFESTS  
FOR OUR CITIZENS THE TWIN PILLARS  
OF DEMOCRACY – PRIVATE PROPERTY  
AND SELF DETERMINATION.”

# 2018 Maricopa County Fall Elections Update

Presented By:  
**REYNALDO VALENZUELA**  
Director of Elections

**ADRIAN  
FONTES**  
COUNTY RECORDER





## Dates and Deadlines

- May 30 90-Day Notice Mailed, August Primary
- July 30 Voter Registration Deadline, August Primary
- August 1 August Primary Ballots Mailed
- August 17 Last Day to Request Mail Ballot
- August 22 Last Day to Return Ballot By Mail (*6 days prior recommended*)
- **August 28 Primary Election Day**
- October 9 Voter Registration Deadline, November General (*Tuesday due to Holiday*)
- October 10 November General Ballots Mailed
- October 26 Last Day to Request Mail Ballot
- October 31 Last Day to Return Ballot By Mail (*6 days prior recommended*)
- **November 6 General Election Day**

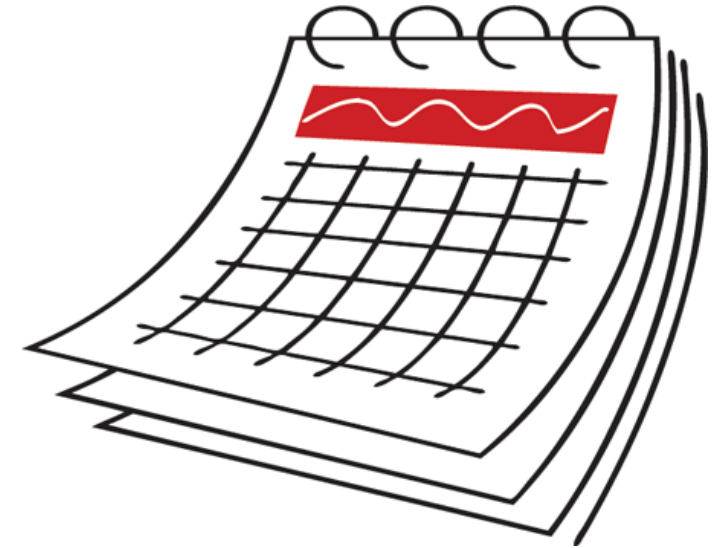



## 2018 Fall Elections – How will voters receive their ballot?

- **Primary Election – August 28, 2018**

- Party Voters will receive their affiliation ballot by mail or at a polling location
- Independent and No Party Designated voters must select a party ballot
  - 90-Day Notification sent to voters urging them to request their ballot
  - Polling Location voters may select their ballot of choice when they vote
- Ballot Request (MCED) – [www.Request.Maricopa.Vote](http://www.Request.Maricopa.Vote)

- **General Election – November 6, 2018**

- All voters will receive the general election ballot whether through PEVL, a one-time mail-ballot request, or at their polling location



# Myth: Independents Cannot Vote in the Primary Election

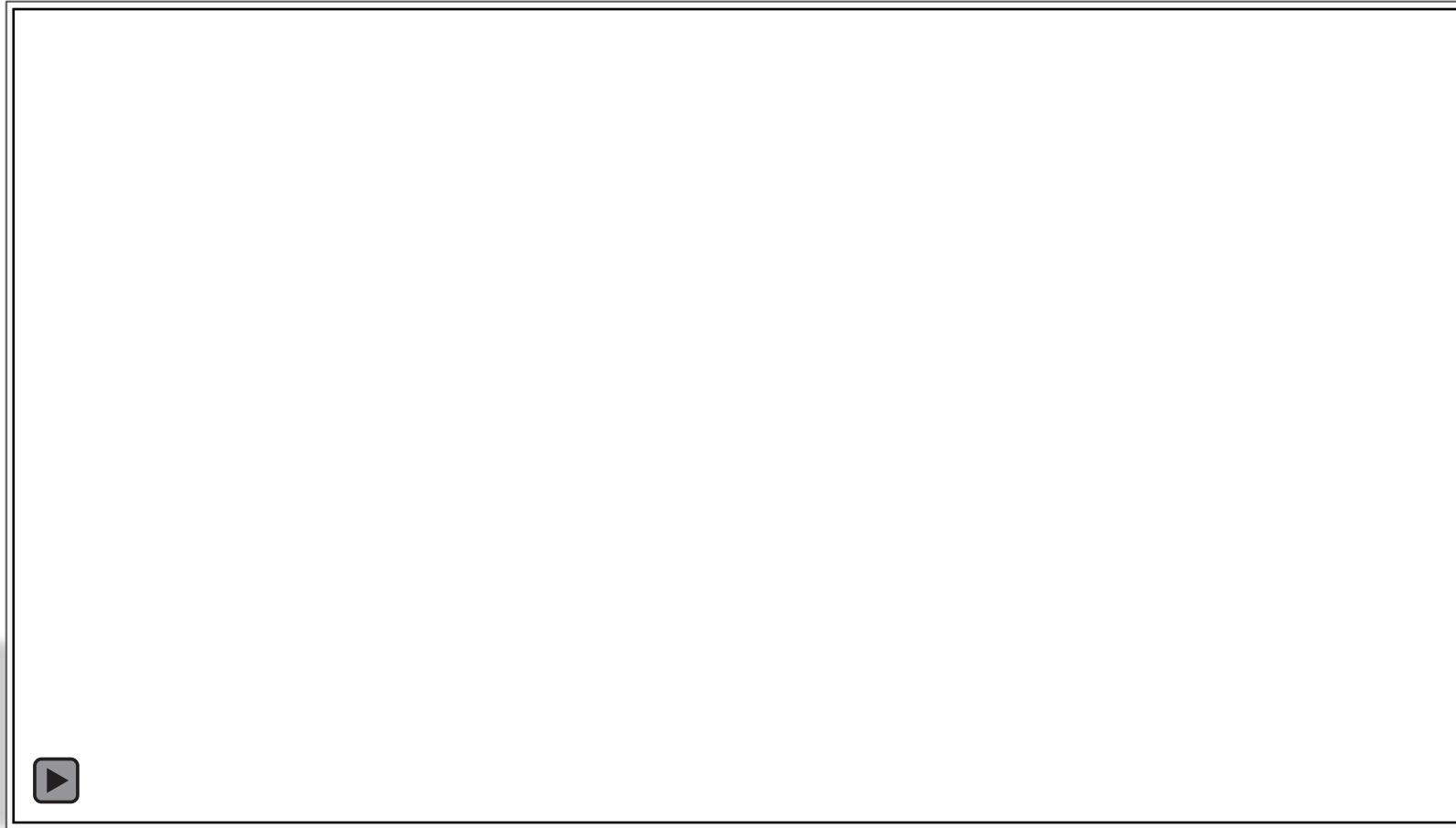



# Independent Voters & Primary Elections

- Arizona statute allows voters who are not registered with a political party to vote in certain primaries and races contained within
- Recorders throughout Arizona provide notice to those voters who would otherwise have received a ballot as a Permanent Early Vote List subscriber. These notices are called 90-Day Notices
- **Independent PEVL subscribers MUST select a party ballot to vote in the Primary**

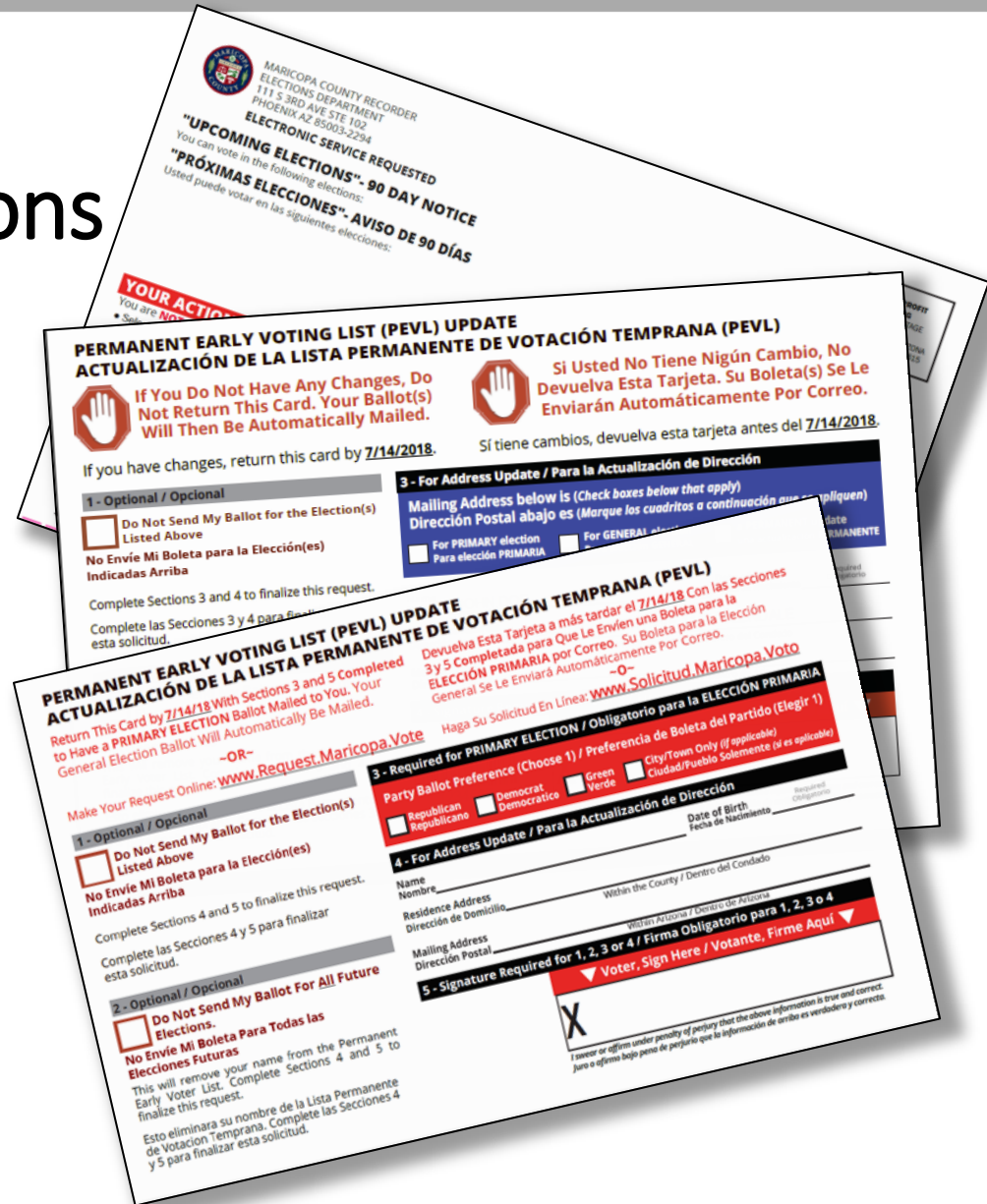



**IND and PND Voters  
MUST Request their Ballot  
for the August 28th PRIMARY**

**[www.Request.Maricopa.Vote](http://www.Request.Maricopa.Vote) or 602-506-1511**

**Even for Non-Partisan  
(City/Town Only) Ballots**



## Consolidated Elections 2018

- During 2018's session, the legislature passed and governor signed House Bill 2604, making voter participation a matter of statewide concern.
  - Political Subdivisions where the turnout experiences a “significant decrease,” starting in 2018, would be required to consolidate their election.
  - The statute requires those cities (including charter cities), municipalities and other political subdivisions move their elections to a “**statewide**” election date.
  - Fall 2018 will be the first metrics measured for those holding elections not currently on consolidated dates.

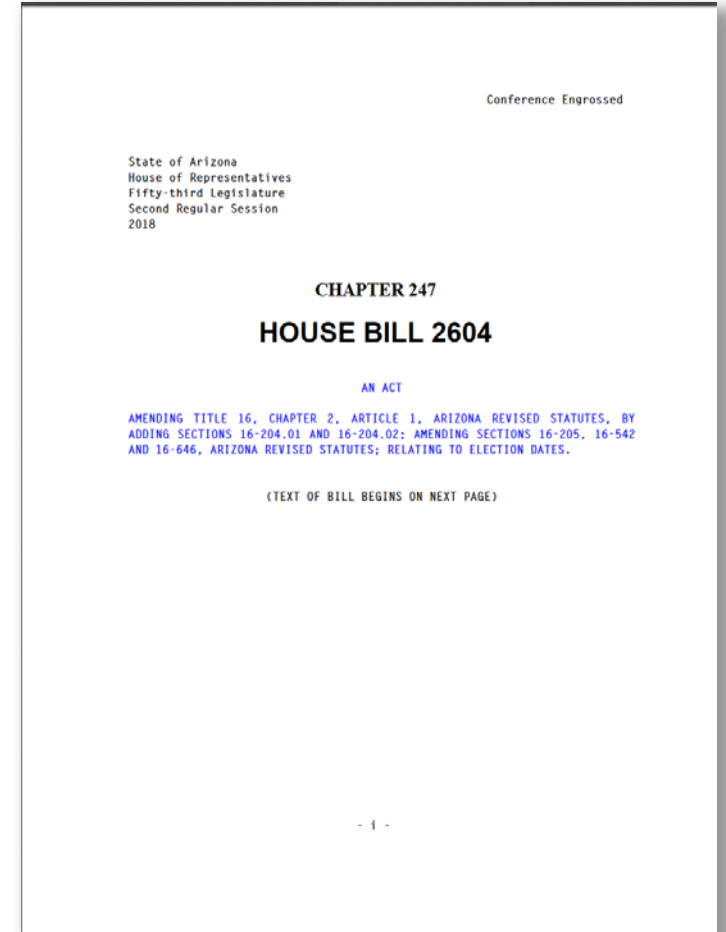



# Consolidated Elections – For Now, What’s to Consider?

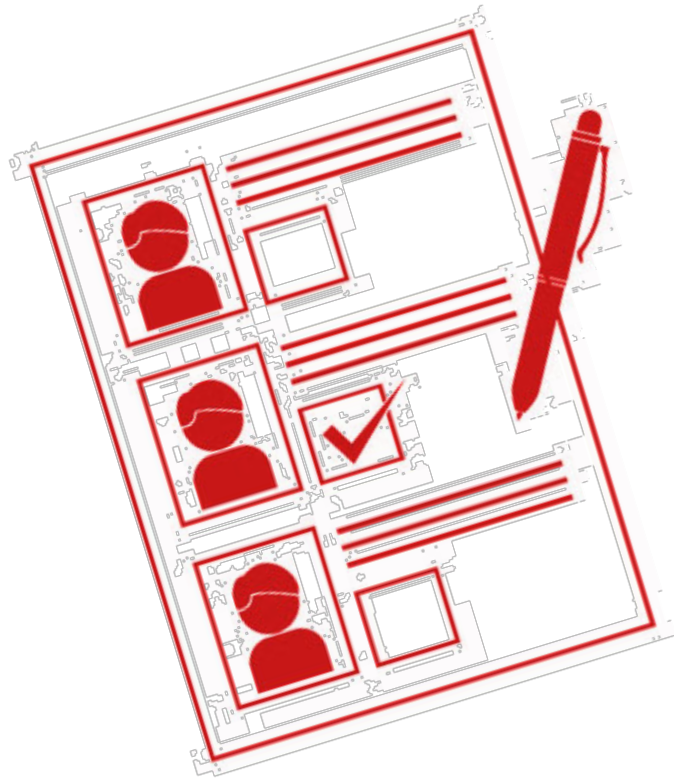

- **Dates to Consider:**
  - The second Tuesday in March
  - The third Tuesday in May
  - The tenth Tuesday before the first Tuesday after the first Monday in November
- **Primary or General Election Dates**
  - Independents must choose their ballot if consolidating to the August ballot
  - Increased ballot length on the November Ballot (*Real Estate!*)
  - Voter Fatigue – Ballot Roll-Off – Voter Drop-Off





MARICOPA COUNTY RECORDER

# Voter Experience



## **Voter Experience:**

- **Where we were... (2016)**
- **What we were looking for...**
- **Where are we now (2017-2018: SiteBook & Ballot-On-Demand System)**
- **Statistics & Election Comparison**

**TELL  
OUR  
STORY**



## Where we were... General Election 2016

### Polling places (724 precincts)

- E-Pollbooks
- In-Precinct Tabulators (Insight)
- Pre-printed ballots
- Edge voting machines
- Central Count Tabulators

### ...and PEVL (Permanent Early Vote List)

- Mail to 1.6 million voters
- Receive and scan for Signature Verification
- Receive and Sort Good-Sig, separate ballot from envelope
- Central Tabulation (1.3 million in 2016 General)



## What we were looking for...

### Create an Election System with:

- ✓ Increased Voter Access/Engagement
- ✓ Improved Security/Accountability
- ✓ Economical and Scalable





## Security and Accountability

- **Reduce points of vulnerability**

- Close Networks
- Encrypt Networks
- Decrease Ballot Handling

- **Professionalize Staff**

- IT Deployment/set-up
- Increase training opportunities
  - Board worker on-site training
  - Cross training
  - Experience-driven Election Day

- **Increase Accountability**

- Ballot Tracking
  - Affidavit Envelope & Signature
  - Mail and Internal Tracking
- Ballot Printing
  - Time, Date Roster (by style)
  - Individual per voter
- Post-Election accounting
- (Reduce waste, 7-10 Pallets of paper per election)



## Where are we now: Front-side, Back-side (HYBRID MODEL - Vote Centers)

### Front-side (voter's view)

- SiteBook Check-in system
  - Touch-screen
  - ID scanner
  - VPN, redundant carrier
  - Custom Software
  - Live-link to VR system
- Ballot-on-Demand Printers
  - Sentio system (proprietary)
  - Ballot AND Envelope printers

### Back-side (department view)

- Signature Verification
  - Inbound Scanning (Runbeck)
  - Signature Verification by trained county staff
- Ballot Count & Tabulation system
  - In-Precinct:
    - Dominion Insight Ver: APX KC 12, HPX K1.44
  - Central Count:
    - OPTECH 400-C Ver: 3.00P



# Election System Equipment

(Maricopa County Vote Centers)

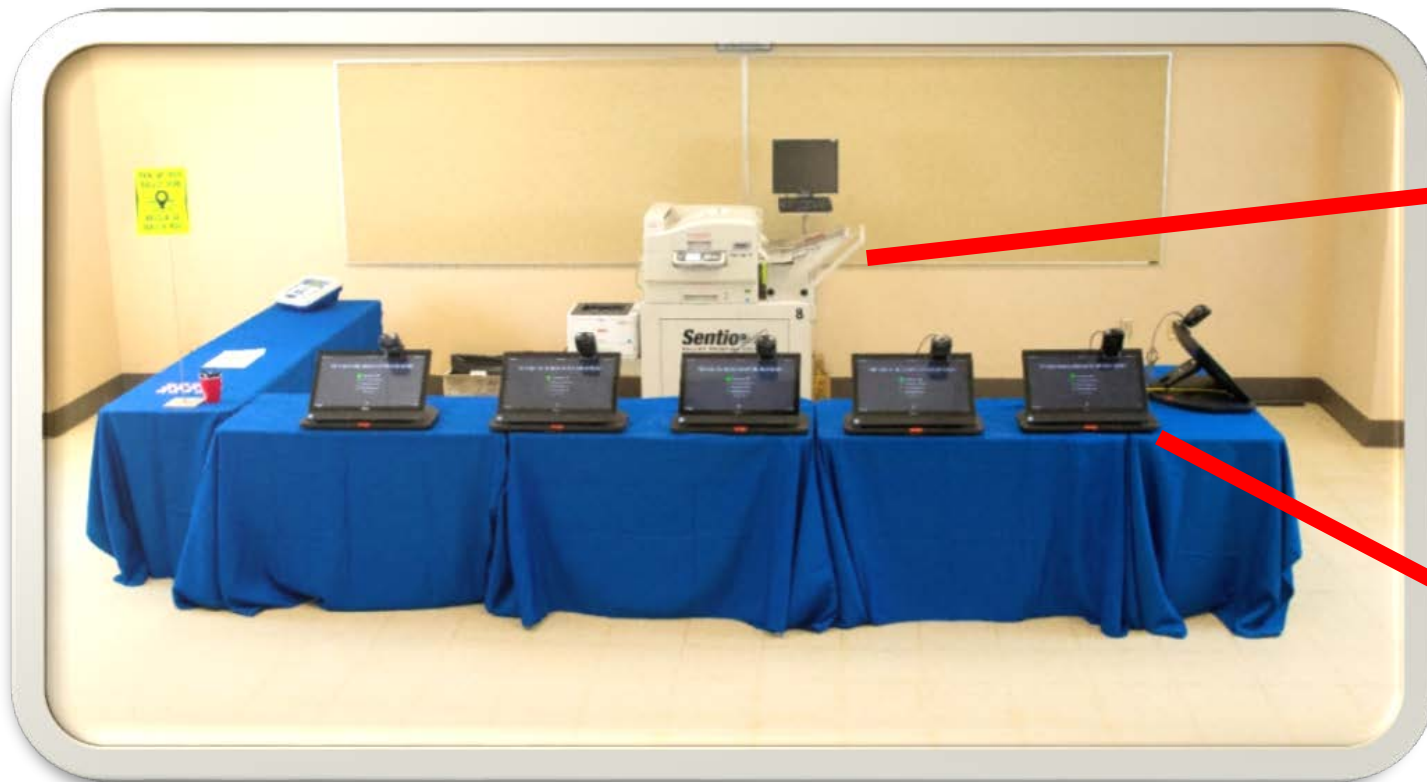

- **Three to Twelve SiteBook Check-In Stations**
- **One to Two Ballot On Demand Printers**



# SiteBook

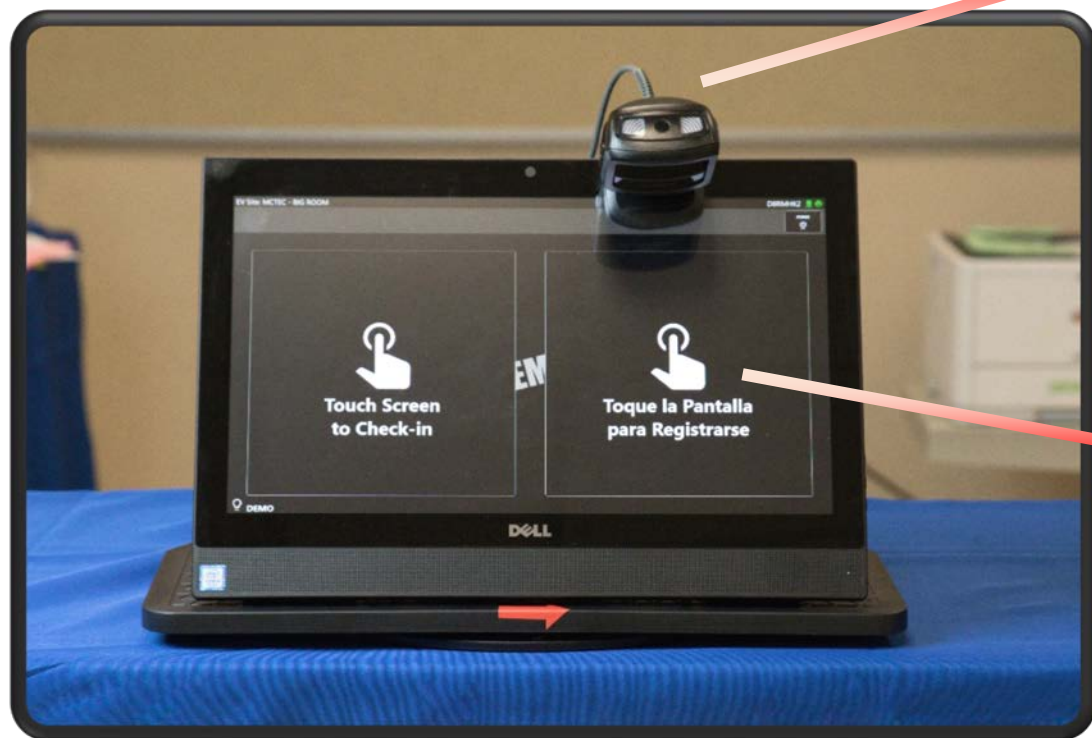

- Barcode Scanner for Licenses, Voter Identification & Digital Voter ID Card

- Touchscreen Interface with Privacy Screens
- Barcode Scanner also used for Board Worker “Gatekeeper” Security Screens
- Mounted on a Rotating Tray to Allow for Board Worker Access from Behind the SiteBook
- Multilingual
- Inverts Black/White Background for Easy Reading





# SiteBook

EV Site: MCTEC - BIG ROOM ID Affirmation 43R1KH2

BACK START OVER

Is this your CURRENT Name?

**KRISTINA KINGSMORE**  
**06-21-1983**

**NO** **YES**

TRAINING

The image shows a screenshot of a software interface for an ID Affirmation process. At the top, it displays the location "EV Site: MCTEC - BIG ROOM", the title "ID Affirmation", and a user ID "43R1KH2". There are "BACK" and "START OVER" buttons in the top left and right corners, respectively. The main question is "Is this your CURRENT Name?". Below the question, the name "KRISTINA KINGSMORE" and the date "06-21-1983" are displayed in a dark box. At the bottom, there are two large buttons: a red "NO" button and a green "YES" button. The "YES" button is highlighted with a thick green border. In the bottom left corner, there is a lightbulb icon and the word "TRAINING".



# SiteBook

EV Site: MCTEC - BIG ROOM Still Live Here 43R1KH2

BACK START OVER

Is this your CURRENT RESIDENCE Address?

4727 E WARNER RD 1029, PHOENIX, 85044  
PHOENIX

**NO** **YES**

💡 TRAINING

BACK  

Maricopa County User Mode Enabled!  
User : MICHAEL ANTHONY JOHNSON

START OVER  

# Is the voter information correct?

<b>First Name</b> KRISTINA	<b>Middle Name</b> 	<b>Last Name</b> KINGSMORE	<b>Name Suffix</b> 	<b>Date Of Birth</b> 06-21-1983
<b>Phone Number</b> (000) 000-0000	<b>Driver License</b> D00074033	<b>SSN 4</b> 8674	<b>Party</b> YES	
<b>Address</b> 5891 E THOMAS RD, SCOTTSDALE, 85251			<b>Unit Number</b> 	

**No**

**Yes**



# Statistics & Election Comparison

## 2017 Jurisdictional Elections

- Average Check-In Time:
  - **Signature Verification on Aff. Envelope used for Identification = 31 Seconds**
- Provisional Balloting:
  - **44 Provisional Ballots Cast**
    - Historical:
      - 2013: ~2,900 (**98.5% reduction**)
      - 2015: ~2,700
  - 14 Valid Ballots Cast

## 2018 Congressional District 8 Primary

- Average Check-In Time:
  - **Board Workers Checking ID at the Polls (Per Statute) = 75 Seconds**
- Provisional Balloting:
  - **531 Provisional Ballots Cast**
    - Historical:
      - 2016 PRI: ~3,200 (**83.5% reduction**)
      - 2016 GEN: ~52,200 (**would have been 9,100 with current system**)
  - 447 Valid Ballots Cast (System Allows for Out-Of-Precinct Voting)



# FEBRUARY 2018 CD8 SPECIAL PRIMARY ELECTION

(All Ballots Counted)

**IN 1 DAY & 16 HOURS**

# APRIL 2018 CD8 SPECIAL GENERAL ELECTION

(All Ballots Counted – Conditional Provisionals Awaiting Voter Action)

**IN 2 DAYS & 20 HOURS**



**MARICOPA COUNTY RECORDER**

# Community Relations Team

The Maricopa County Recorder's Office on the ground Outreach Team



# Outreach Activities: Roundtable Project

Finding community solutions to voting barriers.



New Voter Registering after African American Roundtable



Group photo at Disability Advocates Roundtable



Native American Community Night: Idea from Native American Roundtable



# Outreach Activities: Deputy Registrars

A volunteer core to amplify the message of the Maricopa County Recorder's Office.

43

Trainings Completed

378

Deputy Registrars Trained,  
and counting!



Community Events



Tours and Educational Programs



School Events





# Outreach Activities: School Programs

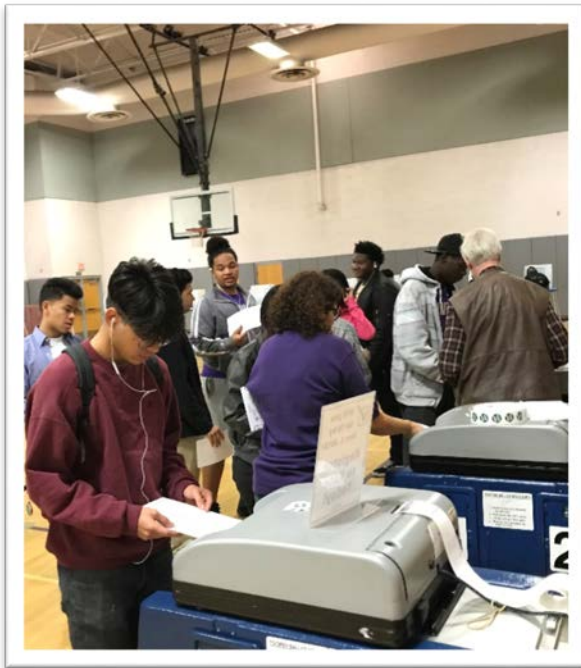

School Elections

+



Voter Registration



+



Guest Speakers

=

# Junior Registrar Program



MARICOPA COUNTY RECORDER

# Questions?

Thank you for attending!

Follow our social media accounts for frequent informational videos on recording and elections:

 /AdrianFontesMCR

 @recorderfontes & @maricopaelex

 @recorderfontes

[www.Maricopa.Vote](http://www.Maricopa.Vote)

[www.Request.Maricopa.Vote](http://www.Request.Maricopa.Vote)

[www.Locations.Maricopa.Vote](http://www.Locations.Maricopa.Vote)

[www.BallotStatus.Maricopa.Vote](http://www.BallotStatus.Maricopa.Vote)

[www.CandidateList.Maricopa.Vote](http://www.CandidateList.Maricopa.Vote)

[www.GetInvolved.Vote](http://www.GetInvolved.Vote)

[www.GetID.Maricopa.Vote](http://www.GetID.Maricopa.Vote)

[www.Calendar.Maricopa.Vote](http://www.Calendar.Maricopa.Vote)

[www.TextSignup.Maricopa.Vote](http://www.TextSignup.Maricopa.Vote)

[www.Register.Maricopa.Vote](http://www.Register.Maricopa.Vote)

Text **"JOIN"** to 628-683

Text **"EV"** to 628-683

[www.AZCleanElections.gov](http://www.AZCleanElections.gov)